

# Snowdon

## Short Description

A traditional alpine style log cabin building with 70mm wall logs and substantial front verandah.

## Features

- Tongue and groove floor and roof boards
- Double Glazed windows and doors
- Double doors with euro cylinder lock
- Glazing bars supplied for fitting if desired
- Adjustable door hinges

## Optional Features

- Mineral roll roofing felt
- Bitumous roof shingles
- Canadian Cedar Shingles
- Extra windows
- Professional Installation
- Timber treatment (at time of installation)
- Electrical wiring to NICEIC / Part P

## Key Dimensions

- External size availability 5x5m (5x6.9 including verandah)
- Height to Eaves 2.1m
- Height to Ridge 2.9m

## Timber Thickness Availability

70mm

44mm

Also available with full length glazed doors

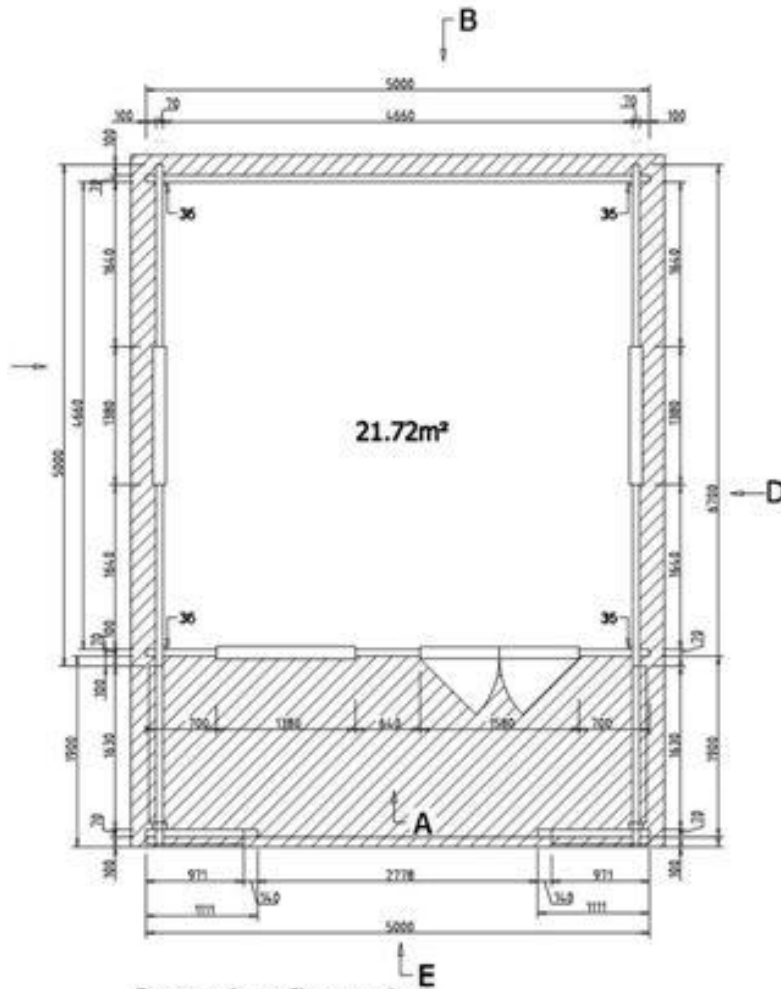

## Snowdon floor plan

Design & specification subject to change without prior notice  
Copyright Ventline Log Cabins

